

Map Document: I:\2020\05\09\2020AA - Midland\10\REV\10_12_2020_SpringCreek.mxd 2/27/2020

**SPRING CREEK
LOMR
WALLER COUNTY, TEXAS**

- Legend**
- CROSS SECTIONS
 - REVISED EXISTING ZONE A
 - CURRENT EFFECTIVE ZONE A
 - 1% ANNUAL CHANCE FLOOD
 - SPRING CREEK
 - SPRING CREEK WATERSHED
 - CONTOURS (2 INTERVAL)

**EXHIBIT 3
TOPOGRAPHIC AND
FLOODPLAIN WORKMAP**

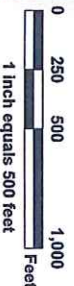
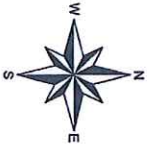

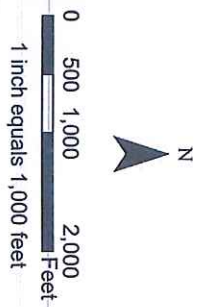
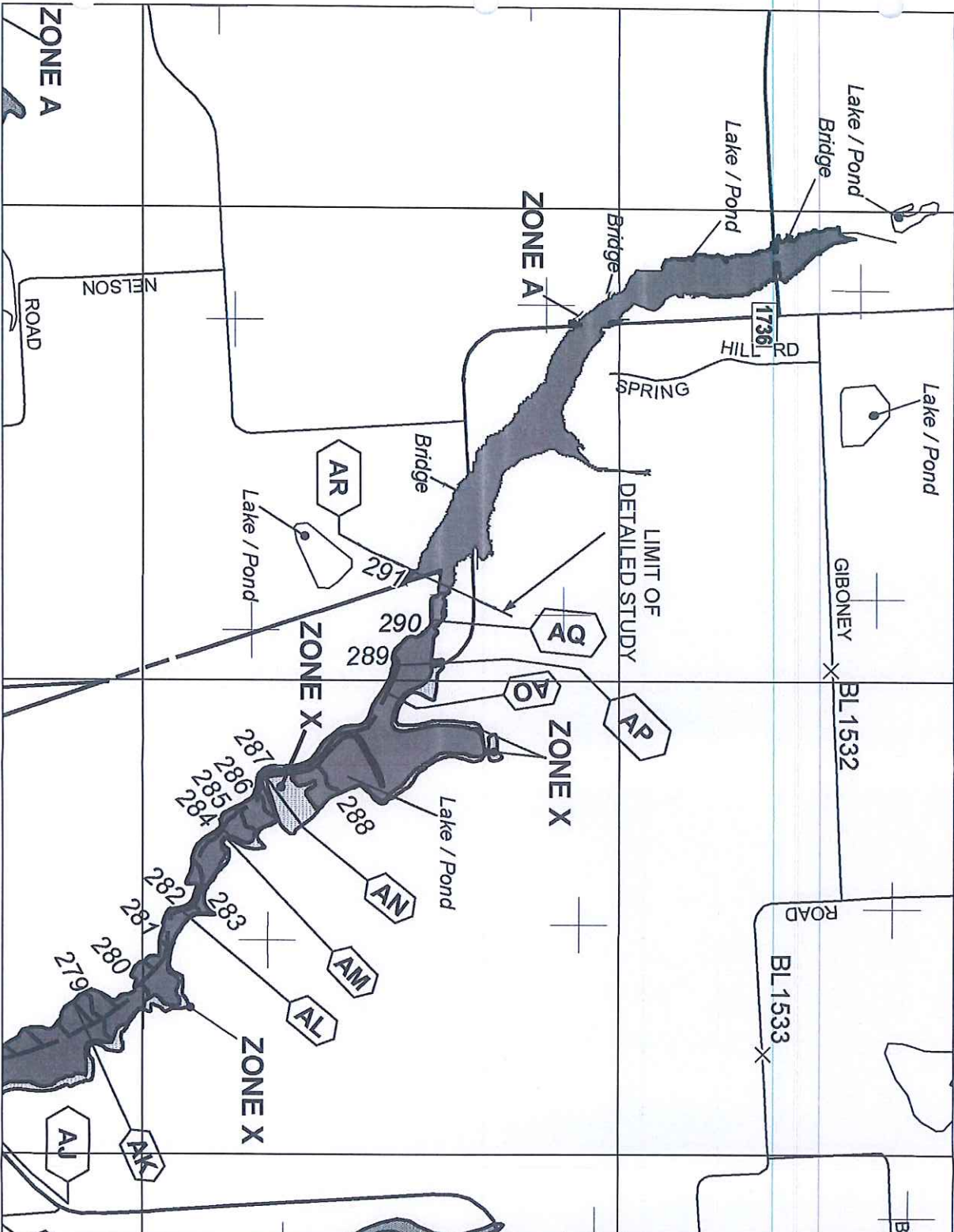

NATIONAL FLOOD INSURANCE PROGRAM

FIRM
FLOOD INSURANCE RATE MAP
 WALLER COUNTY,
 TEXAS
 AND INCORPORATED AREAS

PANEL 73 OF 425
 (SEE MAP INDEX FOR FIRM PANEL, TOWN
 CONTAINS: NUMBER PANEL, SHEET
 WATERWAY: 48494 6035 E

MAP NUMBER: 484730075E
 EFFECTIVE DATE: FEBRUARY 18, 2009

Federal Emergency Management Agency

Notice: This is a Flood Insurance Rate Map (FIRM) and is not a warranty, guarantee, or endorsement of any kind by the Federal Emergency Management Agency (FEMA) for any particular use of the information provided on this map. It is the user's responsibility to determine the accuracy of the information provided on this map. FEMA does not assume any liability for any errors or omissions on this map. This map is provided for informational purposes only.

EXHIBIT 5
 ANNOTATED FIRM

HALFF